

Supplement No. 80

M12 Adapter for in-line sockets from DIN EN 175 301-803 A to DESINA standard

1. General information

This adapter is a cost effective solution when it comes to convert (retrofit) solenoid actuated valves to DESINA standard including LED indicator and protection against inductive cut-off peaks.

The adapter is equipped with a simple plausibility control to detect broken leads, via a bridge between terminal 1 and 2.

The adapter features a integrated flat seal and a central screw M3 to fix it.

2. Available versions, main data

2.1 Adapter conforming DESINA, in-line socket DIN EN 175 301-803 A / plug M12x1

Type	Part No.	Nomenclature
MSUD 41321	8225 0072	Adapter with plug M12, facing upwards (pressure switch)
MSUD 41341	6217 8064	Adapter with plug M12, facing upwards (single stroke solenoid)
MSUD 41441	8225 0092	Adapter with plug M12, facing to the rear (pressure switch)
MSUD 41461	6217 8065	Adapter with plug M12, facing to the rear (single stroke solenoid)

2.2 Additional data

2.2.1 General parameters

Body material	PBT (Polybutylenterephthalat)
Seal material	TPU (thermoplastic Polyurethane)
M12-plug	Thread section out of brass, terminals gold plated
Protection class conf. IEC 60529	IP 65 in properly assembled state
Temperature range	-25°C - +90°C

2.2.2 Electrical parameters

Reference voltage	24 V DC / V AC
Reference current	max. 4 A
Internal consumption	max. 15 mA
Overvoltage protection	47 V (Z-diodes)

2.2.3 Circuitry

Single stroke solenoid

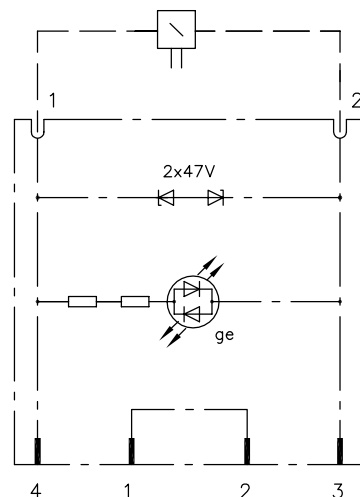

Pressure switch

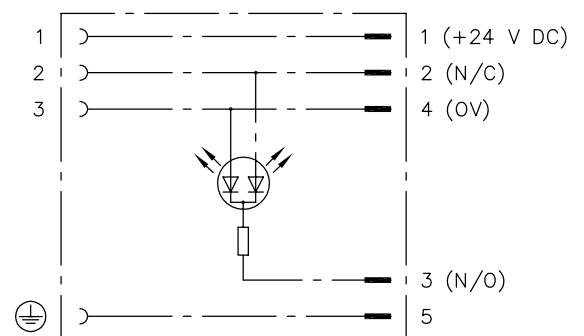

3. Unit dimensions

All dimension in mm and subject to change without notice!

Unit dimensions

MSUD 41321
MSUD 41341

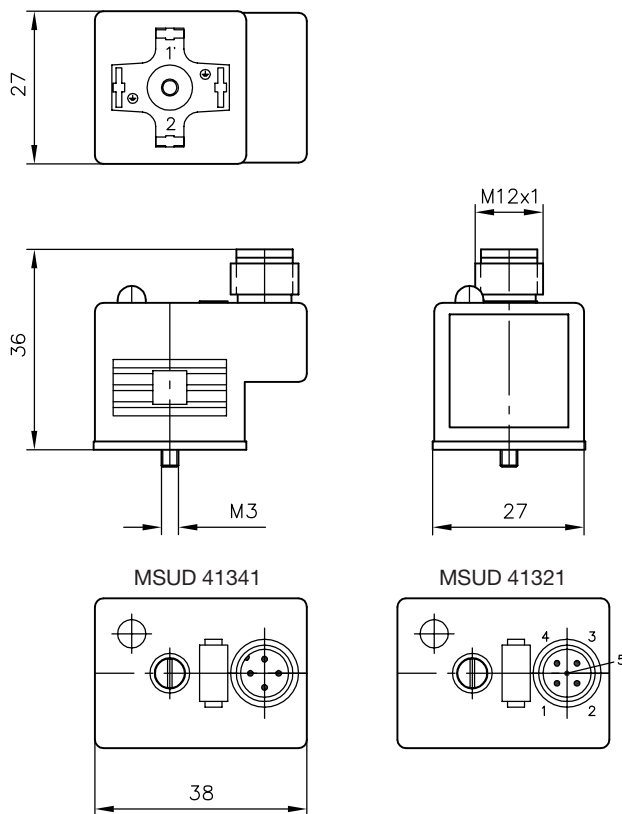

MSUD 41441
MSUD 41461

